

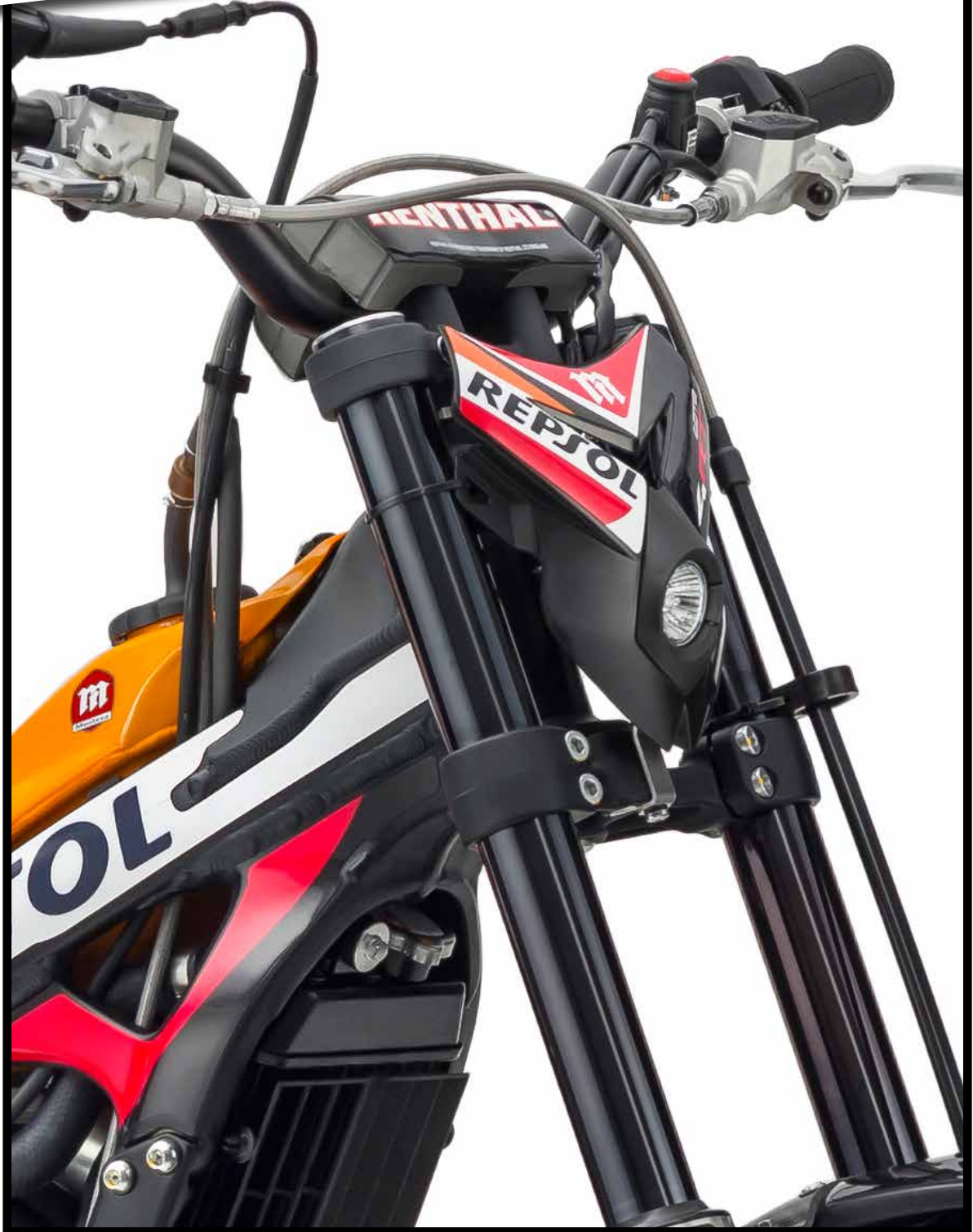

Montesa

COTE 4RT 260



KIT RACE REPLICA 2017

COTA 4RT RACE REPLICA 2017 PART LIST

No	DESCRIPTION	QTY.	TORQUE	REFERENCE	REMARKS
1	STAY FRONT FENDER + TUBE BRACKET	1	10 - 14 N•m (1,0 - 1,4 kgf•m)	61110-REP-SOL	
2	MUFFLER PROTECTOR	1	8 - 12 N•m (0,8 - 1,2 kgf•m)	18347-REP-SOL	Add guard heat RR.
3	CLUTCH COVER PROTECTOR	1	8 - 12 N•m (0,8 - 1,2 kgf•m)	11330-REP-SOL	
4	CARBON FRONT FORK PROTECTOR (SET)	1		53211-REP-SOL	Install using light pressure
5	EXHAUST PIPE PROTECTOR	1	8 - 12 N•m (0,8 - 1,2 kgf•m)	18328-REP-R00	
6	TIE-BAND (150 mm)	1		90602-NN4-600	To fix brake hose to bracket
7	RIVET 4,8 x 14 mm	4		90851-NN4-B00	
8	WASHER, PLAIN 5 mm	4		94101-05000	Upper side
9	SPECIAL WASHER	4		61102-NN3-820	Down side
10	WASHER, MUFFLER PROTECTOR	1		61102-REP-K00	See Set up (page 3)

COTA 4RT RACE REPLICA 2017 STICKERS LIST

No	DESCRIPTION	QTY.	REFERENCE
11	RIMS STICKERS	-	87150-REP-J00
	- FRONT RIM STICKERS	6	
	- REAR RIM STICKERS	6	
12	HEADLIGHT STICKER	1	87143-REP-M20
13	CRANKCASE PROTECTOR STICKER	1	87146-REP-K20
14	SPONSOR STICKER	-	ADHES-REP-006
	- FORK RH STICKER	1	
	- FORK LH STICKER	1	
	- SWING ARM RH STICKER	1	
	- SWING ARM LH STICKER	1	
15	MUFFLER PROTECTOR STICKER	1	87155-REP-M20

COTA 4RT REPSOL 2017 PARTS

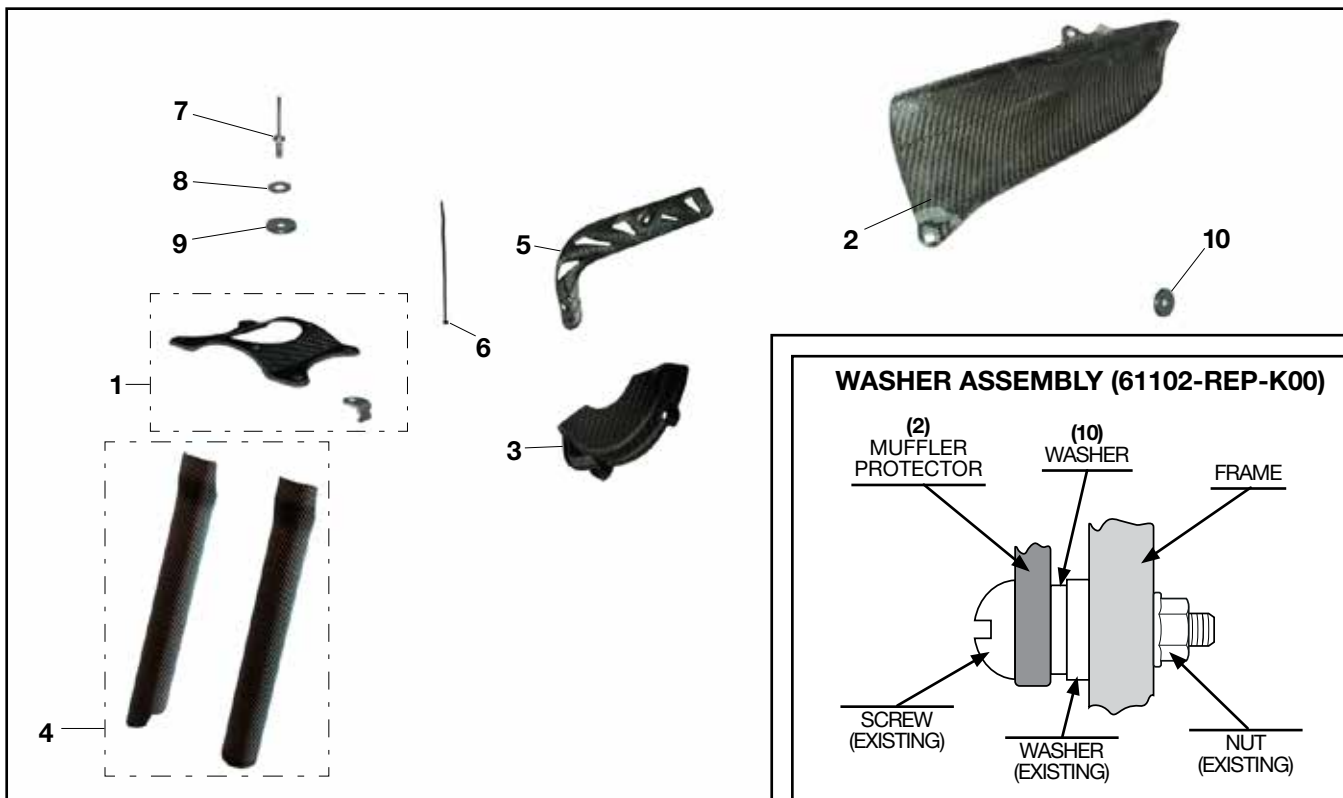

COTA 4RT REPSOL 2017 ADHESIVE

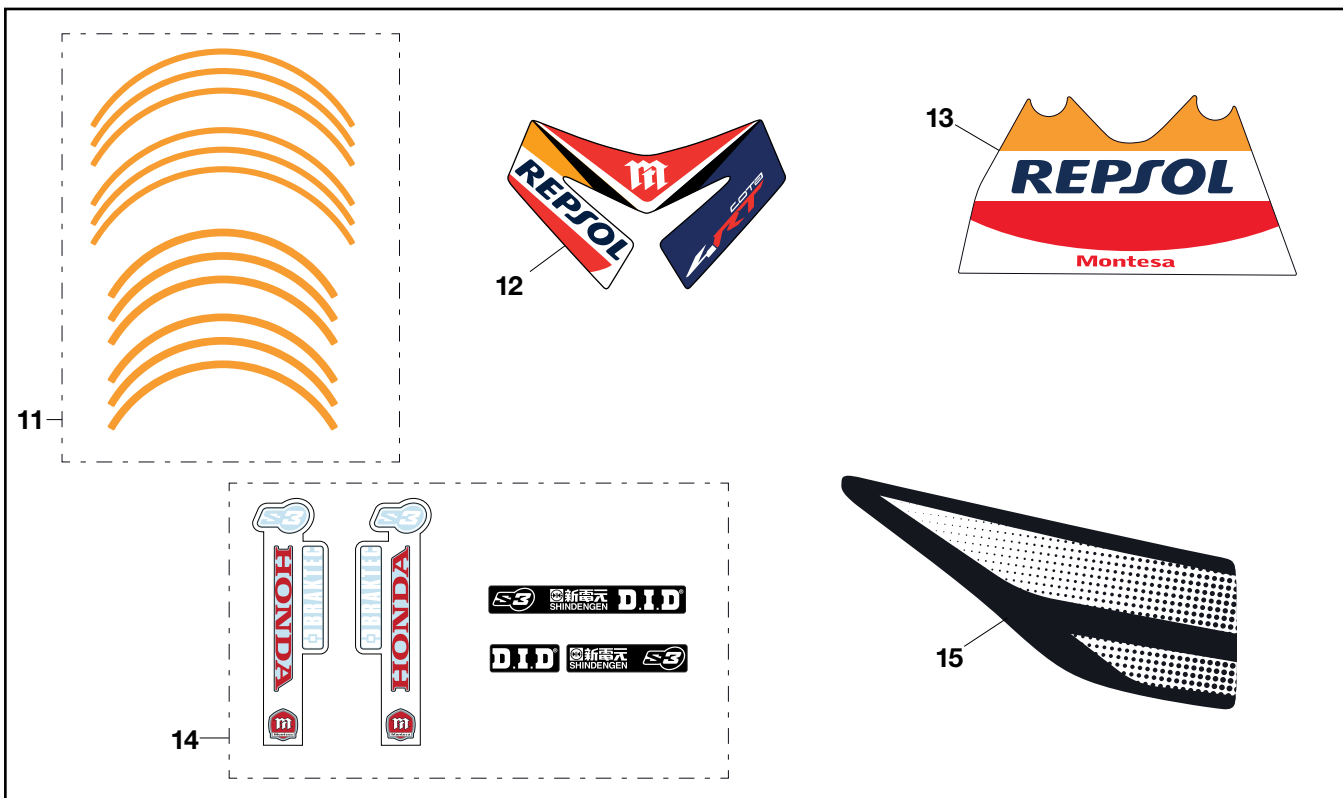

E

POSITION OF PARTS AND STICKERS ON 2017 REPSOL COTA 4RT



2017 HEADLIGHT KIT COMPONENTS

No	DESCRIPTION	QTY.	REFERENCE
1	HEADLIGHT ASSY.	1	61300-REP-026
2	- HEADLIGHT COVER	1	61310-REP-J00
3	- HEADLIGHT SUPPORT	1	61315-REP-J00
4	- SCREW D3,9X10	1	90112-REP-J00
5	- BULB	1	34901-REP-J00
6	- HEADLIGHT WIRING WITH SWITCH	1	32101-REP-L30
7	- TIE-BAND (200 mm)	3	61312-NN4-D10
8	- TIE-BAND (95 mm)	3	90603-NN4-C10
9	HEADLIGHT STICKER STD	1	87143-REP-M10

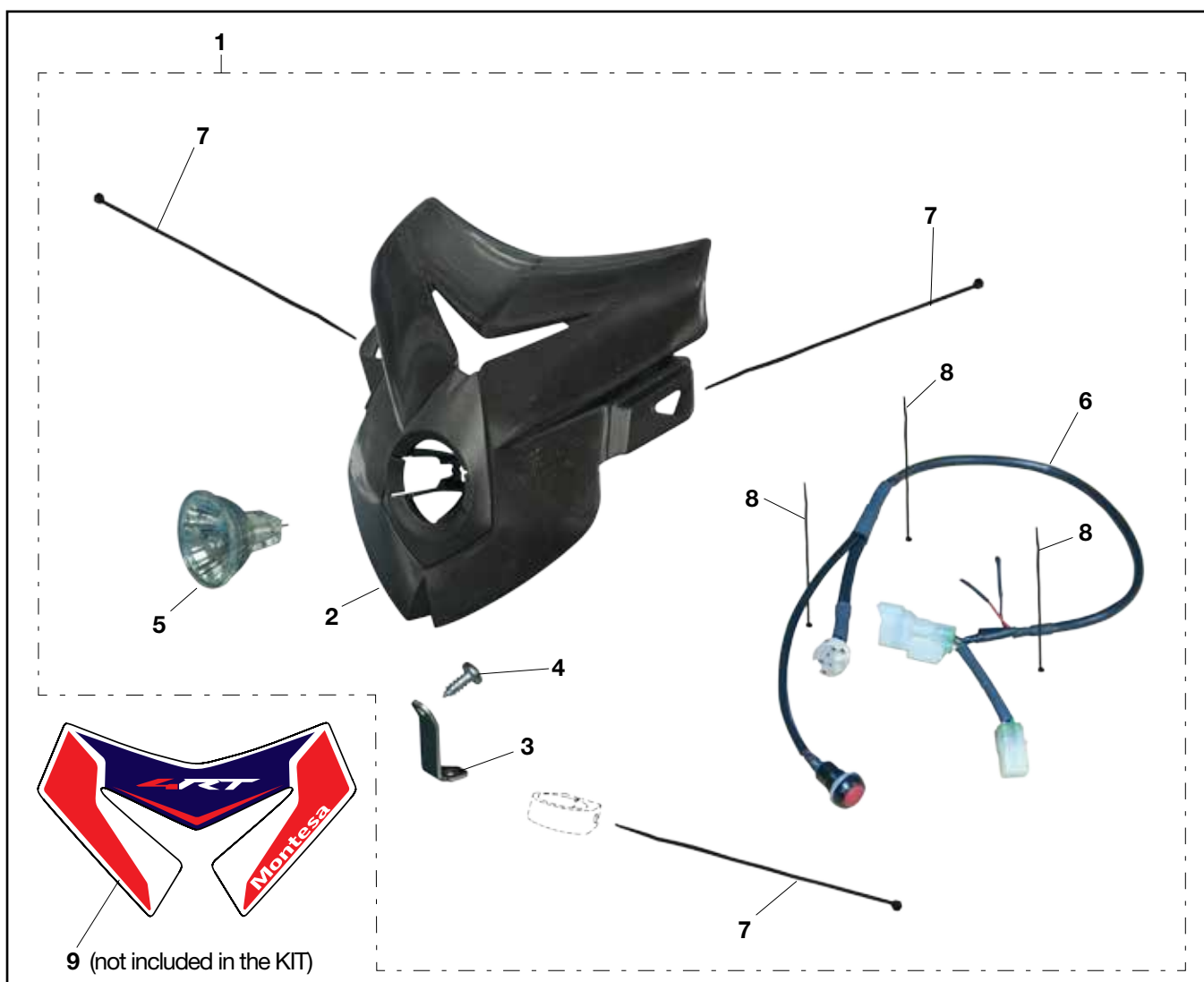

(E)

2017 HEADLIGHT KIT REPLACEMENT PROCEDURE

- Remove the rear fender.
Remove the top and side screws.
- Remove the fuel tank.
Remove the front screw.
Do not lift the tank.
- Remove the fuel injector holder.
- Disconnect the injector by pressing the
clips on the sides.

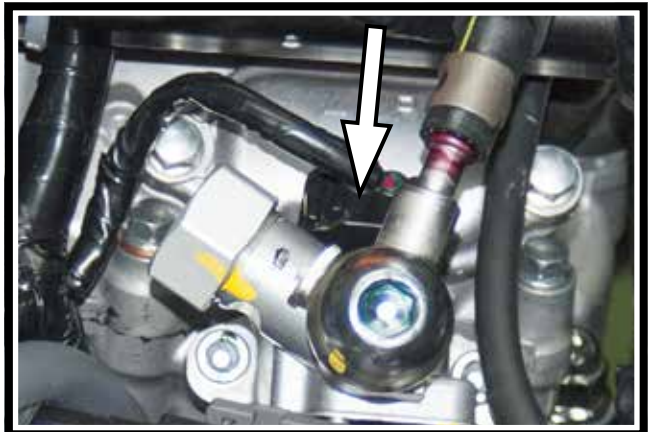

(E)



Carefully lift the petrol tank, being careful not to pull abruptly as the fuel hoses are connected and could be damaged.



- Disconnect the fuel pump black connector (2P).



- Remove the fuel tank.



- Remove the connectors from the protective cable cover.
- Disconnect the 4P connector (a) from lights installation.

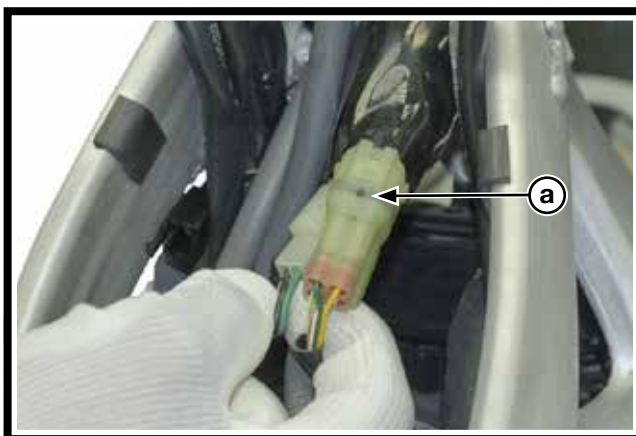

Ⓔ

- Remove the protective cover from the muffler.



- Loosen the filter casing intake flange.



- Remove and extract the filter casing.



- Remove the breather hose from the filter casing.



(E)

- Disconnect the black connector (a) from the front headlight cable.
- Disconnect the white connector (b) from the headlight switch cable.
- Disconnect the connector (c) from the speedometer (rear wheel speed sensor).

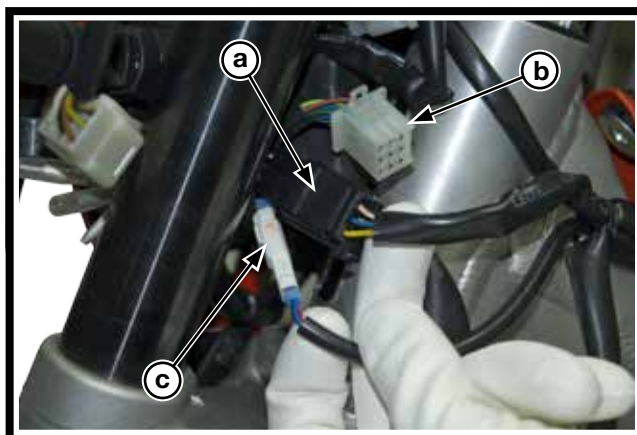

- Disconnect the front brake stop switch cable from the brake lever.



- Cut the cable tie (a).
- Remove the handlebar light switch.

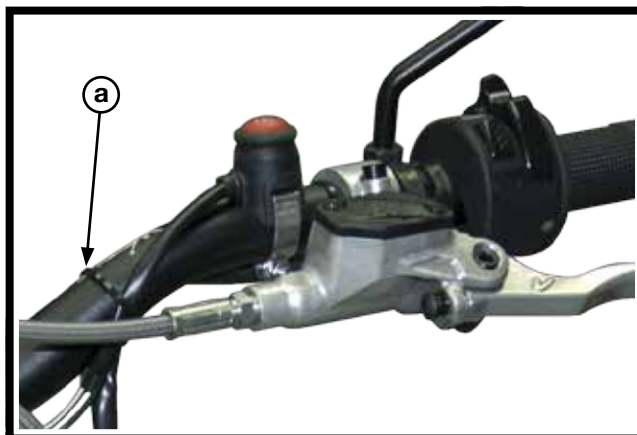

- Disconnect the front turn signal connectors.
- Remove the two side screws from the headlight housing.



(E)

- Remove the bottom screw from the headlight housing.

ATTENTION

Save the screw; it will be used on the new housing.



- Remove the brake hose from the flange on the headlight housing.

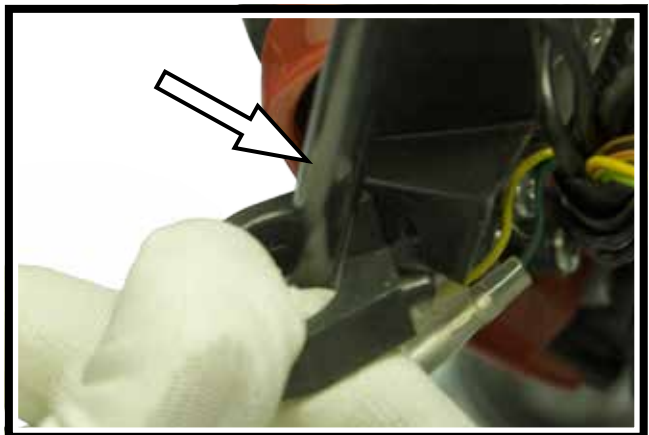

- Release the fan relay from the holder inside the headlight housing.
- Remove the front headlight housing.



- Loosen the two screws on the upper bridge and the four screws on the lower bridge of the fork.

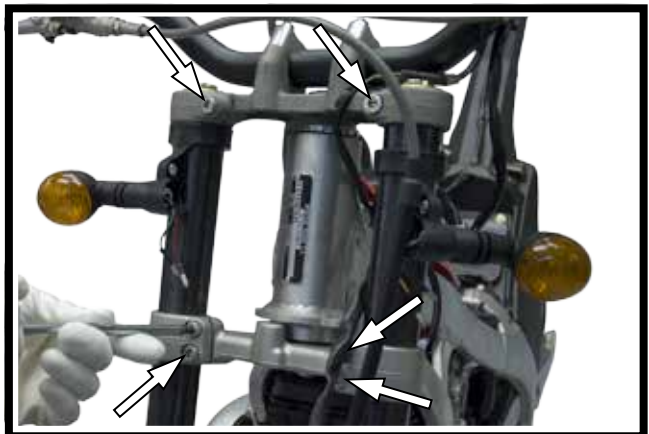

(E)

- Move the fork bars down and remove the headlight housing supports.



- Tech ED/3E:
Position the fork sliders (a) on the upper steering stem (b) so that they are at the level of the upper bridge.

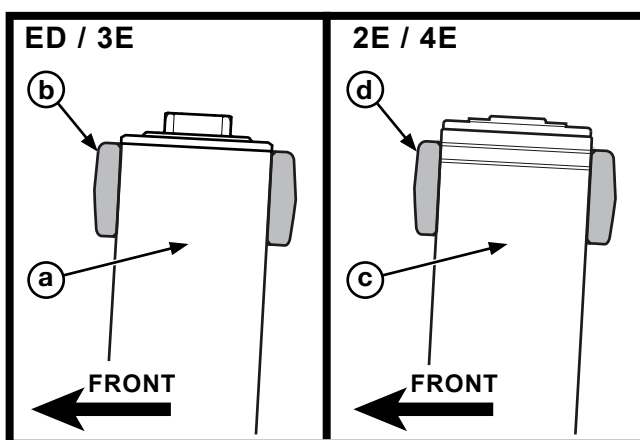

- Showa 2E/4E:
Place the forks legs (c) in the bottom bridge (d) at the first slot

- Tighten the six screws on the fork bridges.

Torque: 21 N•m (2.1 kgf•m)

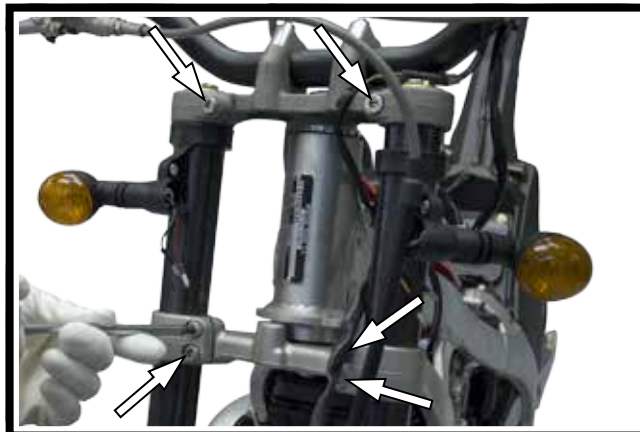

- Remove the gas cable from the gas grip.



E

- Replace the gas cable between the fork bridges.



- Reassemble the gas cable in the throttle housing.
Replace the cover on the throttle housing.



- Remove the clutch lever assembly.



- Replace the clutch hose between the fork bridges, between the gas cable and the brake hose as shown.
- Reassemble the clutch lever assembly on the handlebar.



Torque: 3.2 N•m (0,33 kgf•m)

(E)

- Attach the metal bracket (61315-REP-J00) supplied in the kit on the bottom of the housing using the screw (90112-REP-J00) supplied in the kit.
- Insert the bulb (34901-REP-J00) in the new headlight housing compartment (61310-REP-J00) supplied in the kit. Press down on the bulb until you hear a click.
- Attach the new headlight wire harness (32101-REP-L30).
- Place the headlight switch (a) inside the headlight housing.
- Connect the wire harness to the bulb (b).
- Fix the switch wire harness with a tie-band (c) (90603-NN4-C10).
- Fix the switch wire harness and the headlight wire harness with a tie-band (d) (90603-NN4-C10).
- Assemble the headlight kit (61300-REP-026) on the COTA. Use the same screw removed from the housing.



Ⓔ

- Attach the headlight housing on the top using the two cable ties (61312-NN4-D10).
- Connect the new headlight wire harness to the connector on the main harness.
- For models with Map Switch, connect the (a) connector of headlight wire harness (32101-REP-L30) to map switch connector.
- Fasten the wire harness on the headlight and the gas cable with a cable tie (61312-NN4-D10) on the left side of the frame.

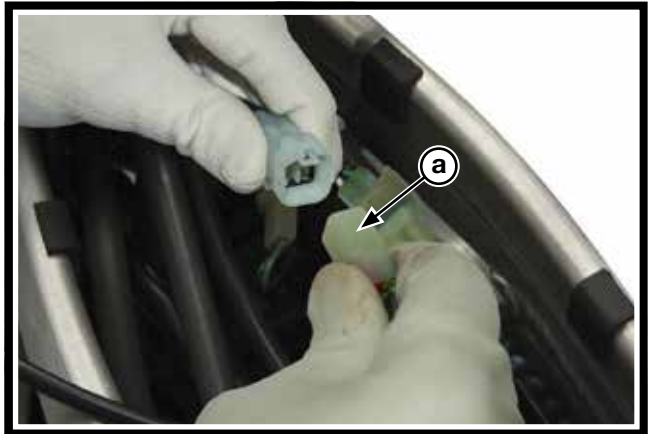

(E)

- Disconnect the connector from the taillights wire harness.
- Remove the taillights wire harness.



- Disconnect the connectors from the horn cable.
- Remove the horn.

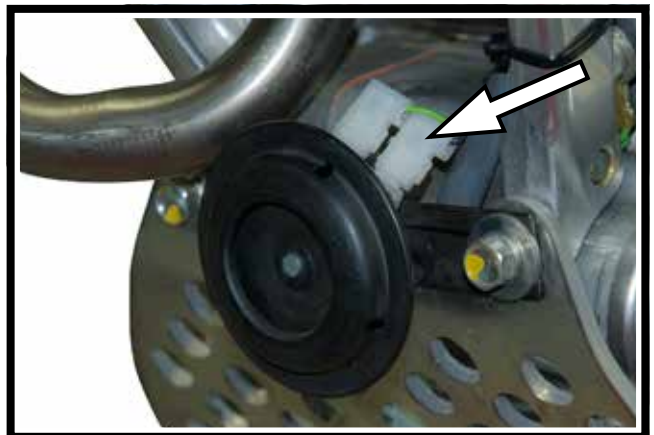

- Disconnect the cable from the rear brake switch.
- Remove the rear brake switch.



- Remove the speed sensor from the bracket.
- Loosen the flanges on the swingarm and remove the sensor wire.
- Tighten the flanges, holding the rear brake hose once again.



Ⓔ

- Remove the section of the wire harness that is no longer being used.



- Install the fan relay in its new location under the insulator, on the adjuster bracket.



- Remove the relay.
- Pass the relay connector under the two oil chamber breather tubes.



- Cut the cable tie and install the relay cable next to the main wire harness.



(E)

- Reattach the relay cable and the wire harness using a new cable tie.



- Bend the relay cable down, behind the wire harness.



- Pass the relay cable under the adjuster bracket tab.



- Connect the fan relay and attach it to the bracket.

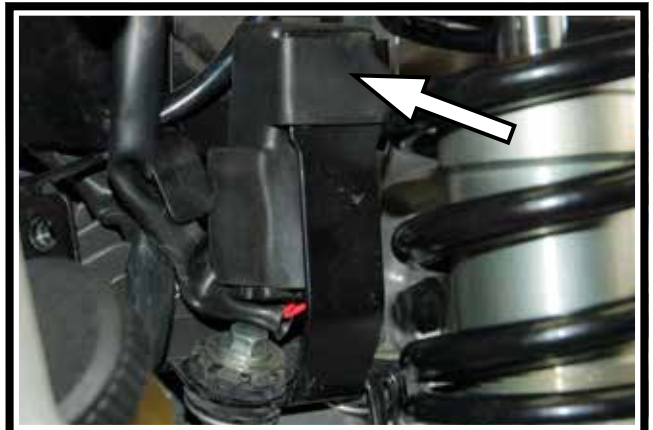

(E)

- Fit the filter casing.

Torque: 10 - 14 N•m (1,0 - 1,4 kgf•m)

- Connect the breather tube in the filter casing.



- Tighten the filter casing intake flange.

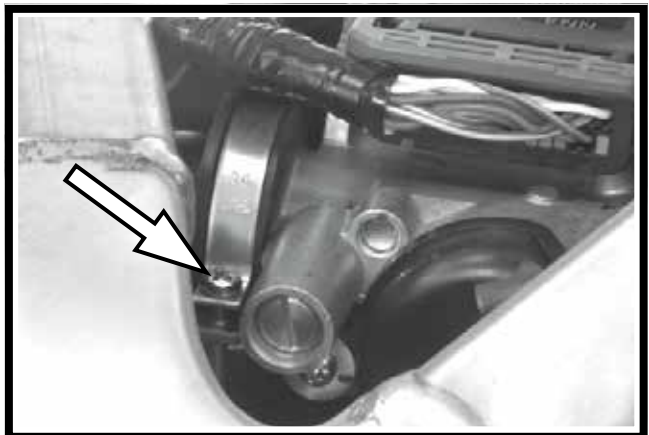

- Fit the fuel tank.
When fitting the tank, be sure to place tubes and cables in the right places.
- Ensure the injection pump/tank suction hose passes properly under the gas wire.
- Connect the fuel pump black connector 2P.



- Position the wires and tubes correctly.



(E)

- Fit the fuel holder (a).

Torque: 8 - 12 N•m (0,8 - 1,2 kgf•m)



Ensure that the injector O-ring is in the correct position.

- Fit the injector connector (b).
- Fit the protective cover from the muffler.

Torque: 10 - 14 N•m (1,0 - 1,4 kgf•m)

- Fit the rear fender.

Torque: 8 - 12 N•m (0,8 - 1,2 kgf•m)

