

**2015**

**COTE** **RT** **260**



**KIT RACE REPLICA**

## COTA 4RT RACE REPLICA 2015 PART LIST

No	DESCRIPTION	QTY.	TORQUE	REFERENCE	REMARKS
1	STAY FRONT FENDER + TUBE BRACKET	1	10 - 14 N•m (1,0 - 1,4 kgf•m)	61110-REP-SOL	
2	MUFFLER PROTECTOR	1	8 - 12 N•m (0,8 - 1,2 kgf•m)	18347-REP-SOL	Add guard heat RR.
3	CLUTCH COVER PROTECTOR	1	8 - 12 N•m (0,8 - 1,2 kgf•m)	11330-REP-SOL	
4	CARBON FRONT FORK PROTECTOR (SET)	1		53211-REP-SOL	Install using light pressure
5	EXHAUST PIPE PROTECTOR	1	8 - 12 N•m (0,8 - 1,2 kgf•m)	18328-REP-SOL	
6	TIE-BAND (150 mm)	1		90602-NN4-600	To fix brake hose to bracket
7	RIVET 4,8 x 14 mm	4		90851-NN4-B00	
8	WASHER, PLAIN 5 mm	4		94101-05000	Upper side
9	SPECIAL WASHER	4		61102-NN3-820	Down side
10	WASHER, MUFFLER PROTECTOR	1		61102-REP-K00	See Set up (page 3)

## COTA 4RT RACE REPLICA 2015 STICKERS LIST

No	DESCRIPTION	QTY.	REFERENCE
11	RIMS STICKERS	-	87150-REP-J00
	- FRONT RIM STICKERS	6	
	- REAR RIM STICKERS	6	
12	HEADLIGHT STICKER	1	87143-REP-K20
13	CRANKCASE PROTECTOR STICKER	1	87146-REP-K20
14	SPONSOR STICKER	-	ADHES-REP-006
	- FORK RH STICKER	1	
	- FORK LH STICKER	1	
	- SWING ARM RH STICKER	1	
	- SWING ARM LH STICKER	1	
15	FUEL TANK STIKER	-	ADHES-REP-005
	- T. BOU STICKER	1	
	- T. FUJINAMI STICKER	1	
16	MUFFLER PROTECTOR STICKER	1	87155-REP-K20

## COTA 4RT REPSOL 2015 PARTS

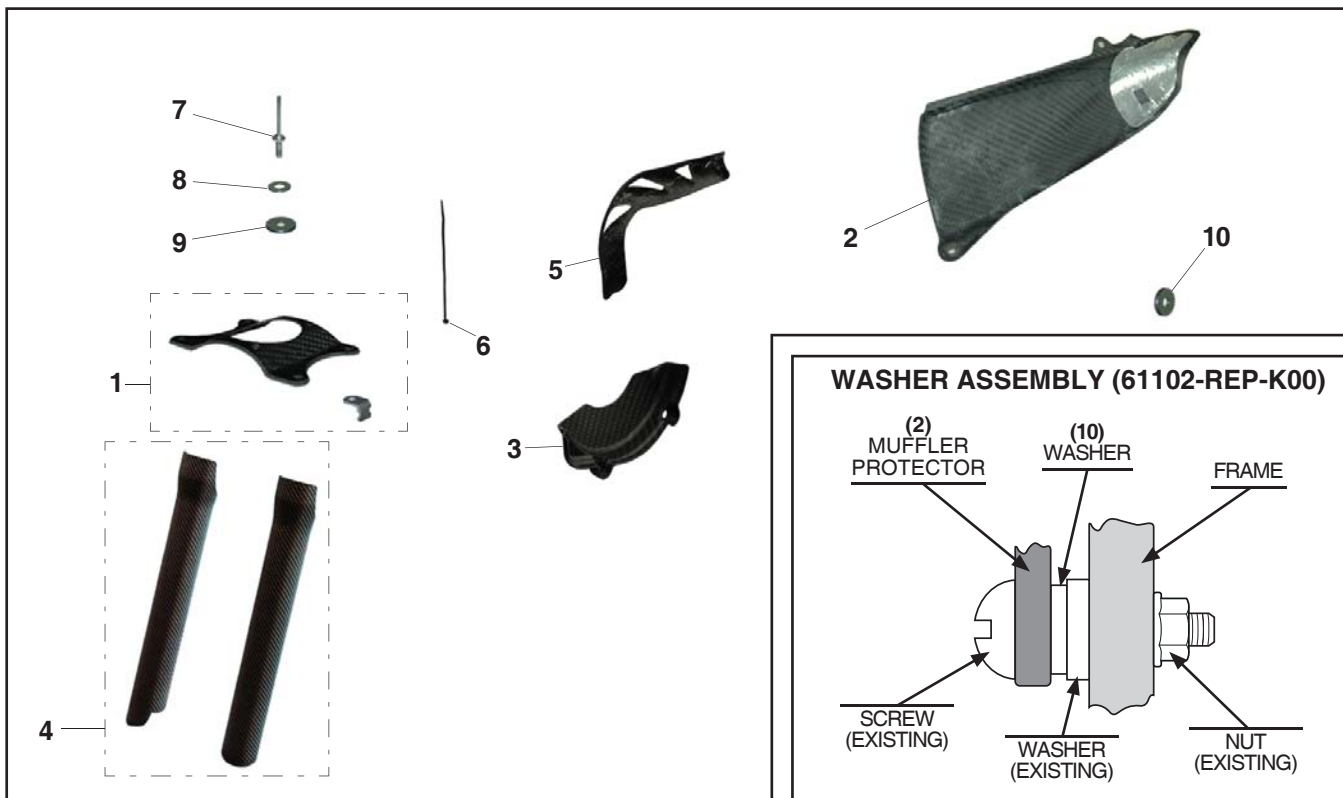

## COTA 4RT REPSOL 2015 ADHESIVE

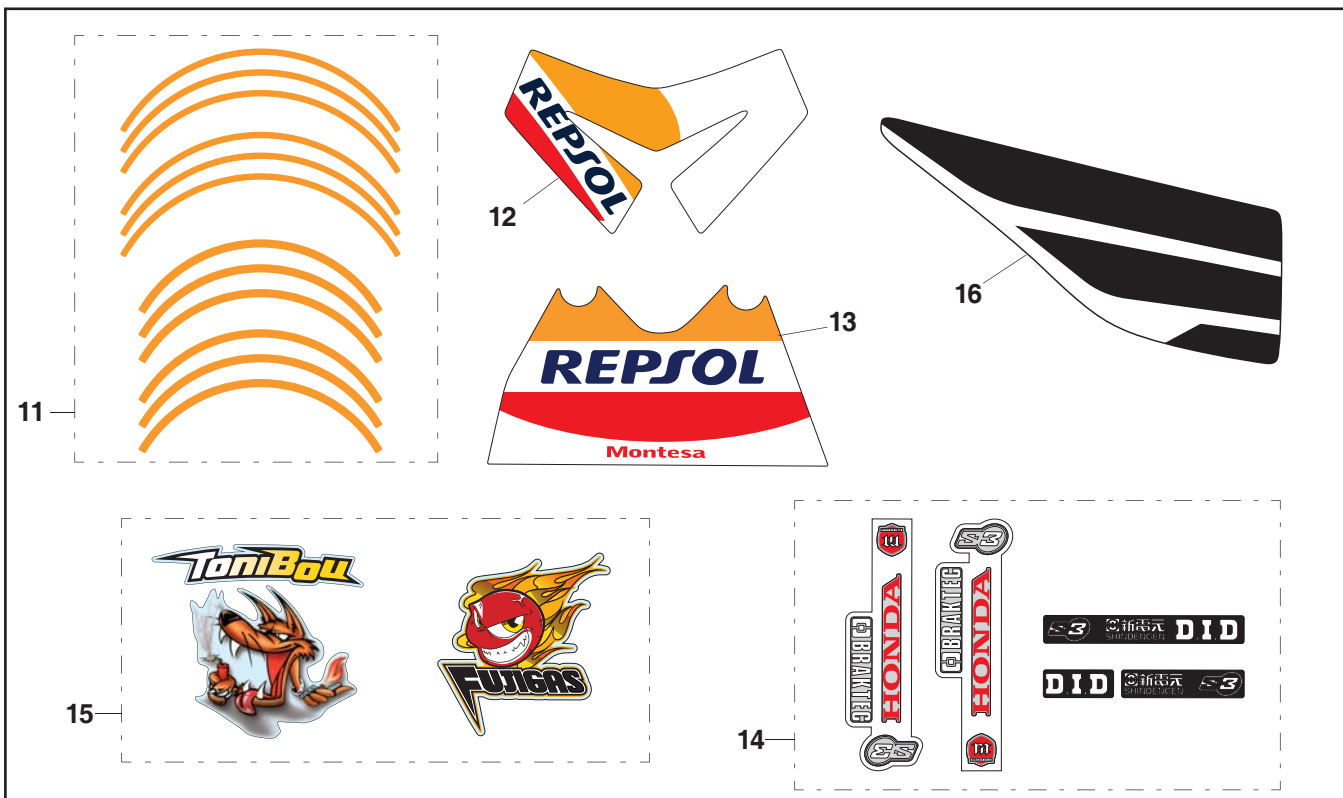



## POSITION OF PARTS AND STICKERS ON 2015 REPSOL COTA 4RT



## 2015 HEADLIGHT KIT COMPONENTS

No	DESCRIPTION	QTY.	REFERENCE
1	HEADLIGHT ASSY.	1	61300-REP-K01
2	- HEADLIGHT COVER	1	61310-REP-J00
3	- HEADLIGHT SUPPORT	1	61315-REP-J00
4	- SCREW D3,9X10	1	90112-REP-J00
5	- BULB	1	34901-REP-J00
6	- HEADLIGHT WIRING WITH SWITCH	1	32101-REP-K00
7	- TIE-BAND (200 mm)	3	61312-NN4-D10
8	- TIE-BAND (95 mm)	3	90603-NN4-C10
9	HEADLIGHT STICKER STD	1	87143-REP-K10

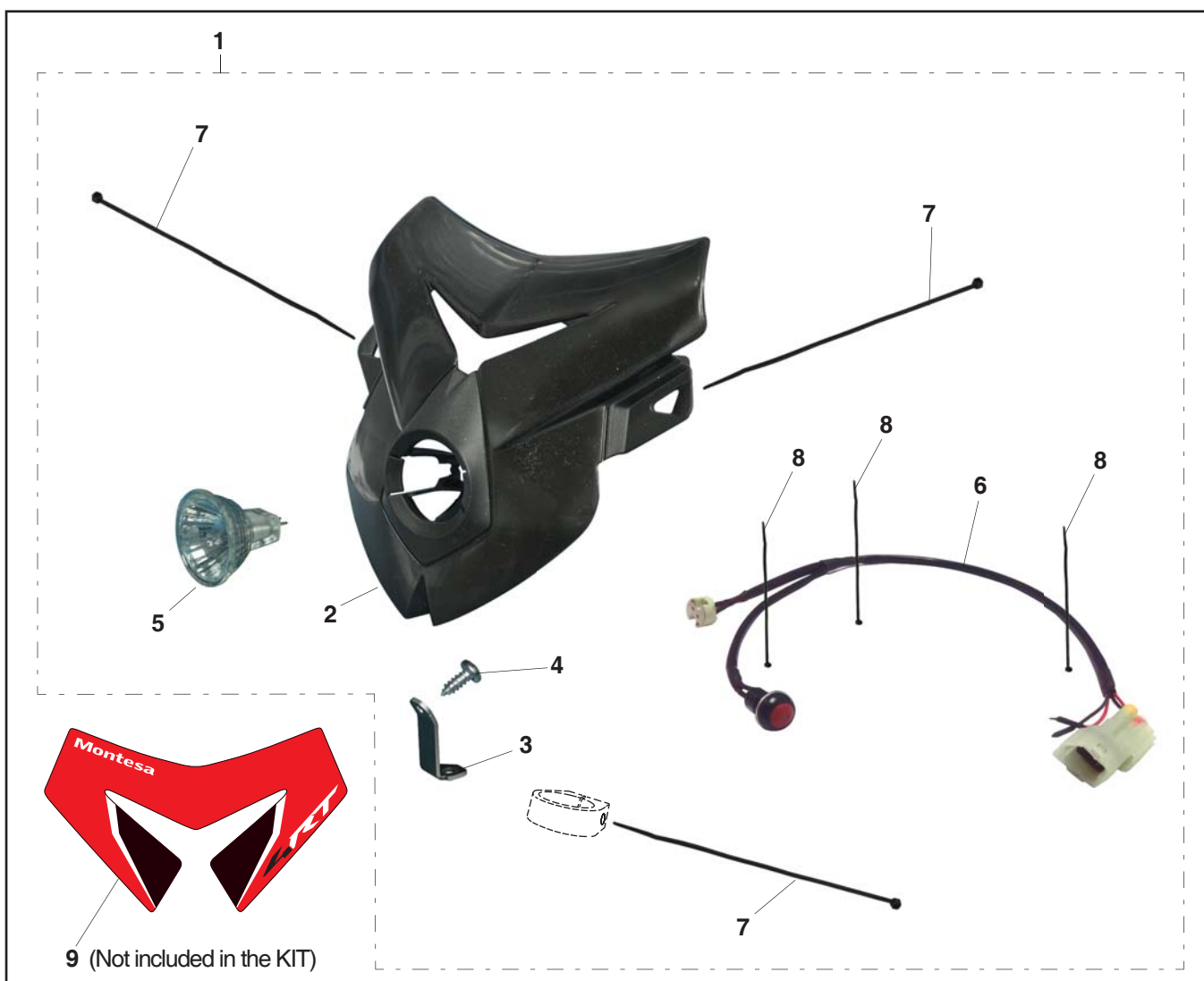

(E)

## 2015 HEADLIGHT KIT REPLACEMENT PROCEDURE

- Remove the rear fender.  
Remove the top and side screws.
- Remove the fuel tank.  
Remove the front screw.  
Do not lift the tank.
- Remove the fuel injector holder.
- Disconnect the injector by pressing the clips on the sides.

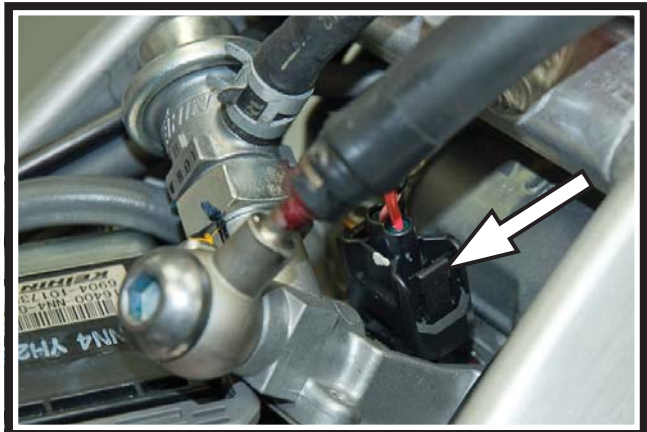



(E)

- Disconnect the suction hose from the cylinder head.



Carefully lift the petrol tank, being careful not to pull abruptly as the fuel hoses are connected and could be damaged.



- Disconnect the fuel pump black connector (2P).



- Remove the fuel tank.



(E)

- Remove the connectors from the protective cable cover.
- Disconnect the 4P connector (a) from lights installation.



- Remove the protective cover from the muffler.



- Remove the exhaust pipe clamp.



- Remove the silencer attachment bolt (a).
- Remove the muffler.





(E)

- Loosen the filter casing intake flange.



- Remove and extract the filter casing.



- Remove the breather hose from the filter casing.



- Disconnect the black connector (a) from the front headlight cable.
- Disconnect the white connector (b) from the headlight switch cable.
- Disconnect the connector (c) from the speedometer (rear wheel speed sensor).

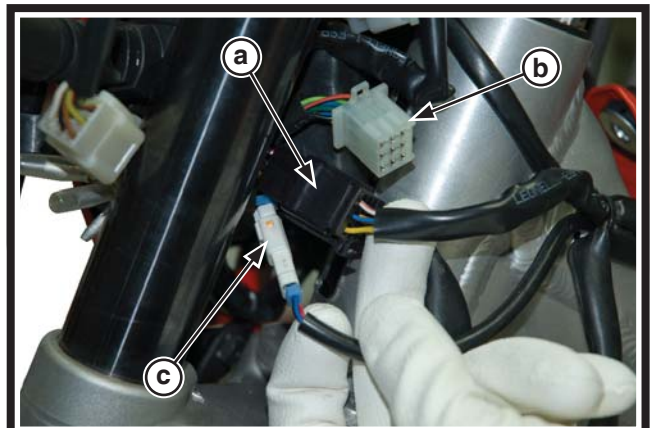

(E)

- Disconnect the front brake stop switch cable from the brake lever.
- Remove the stop switch.  
Replace the switch with a spring and an M5x12 bolt (not supplied in the kit).

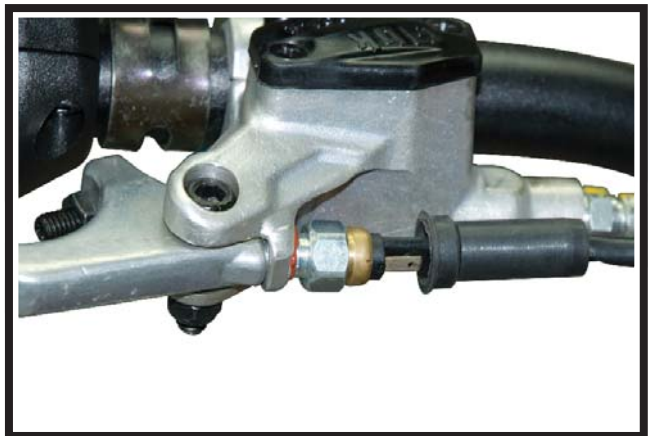

- Cut the two cable ties.
- Remove the handlebar light switch.

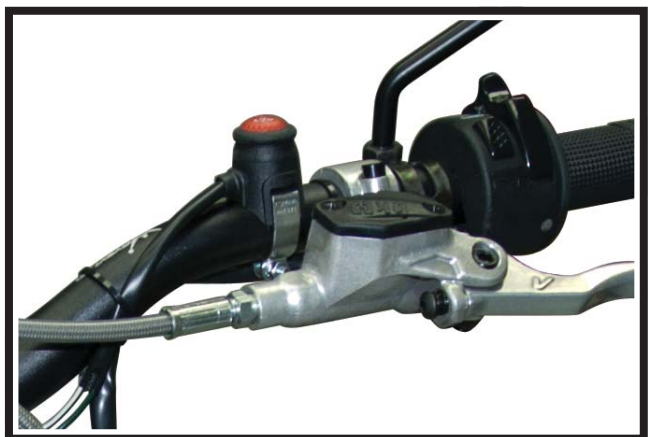

- Disconnect the front turn signal connectors.
- Remove the two side screws from the headlight housing.



- Remove the bottom screw from the headlight housing.

**ATTENTION**

Save the screw; it will be used on the new housing.



Ⓔ

- Remove the brake hose from the flange on the headlight housing.

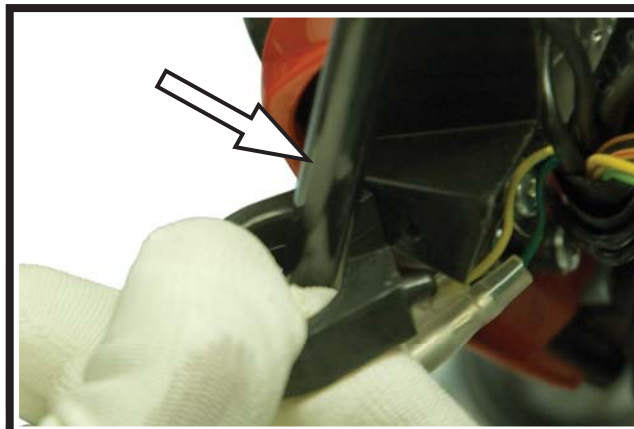

- Release the fan relay from the holder inside the headlight housing.
- Remove the front headlight housing.

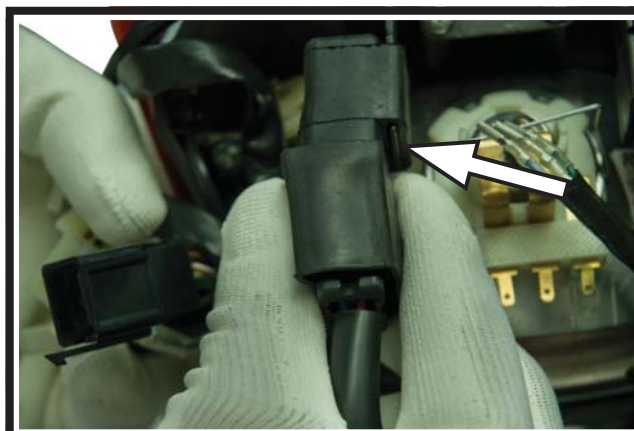

- Loosen the two screws on the upper bridge and the four screws on the lower bridge of the fork.

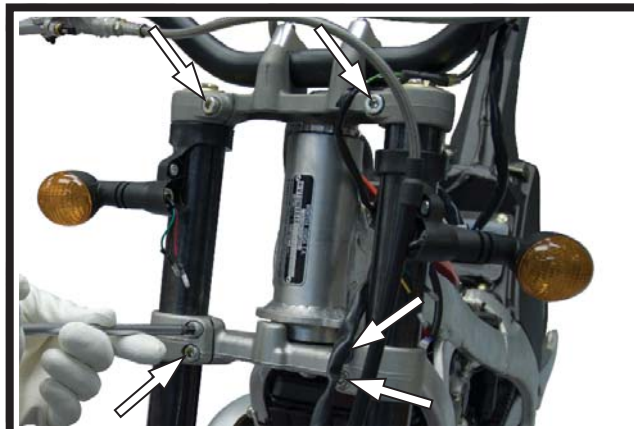

- Move the fork bars down and remove the headlight housing supports.





(E)

- Tech ED/3E:  
Position the fork sliders (a) on the upper steering stem (b) so that they are at the level of the upper bridge.
- Showa 2E/4E:  
Place the forks legs (c) in the bottom bridge (d) at the first slot

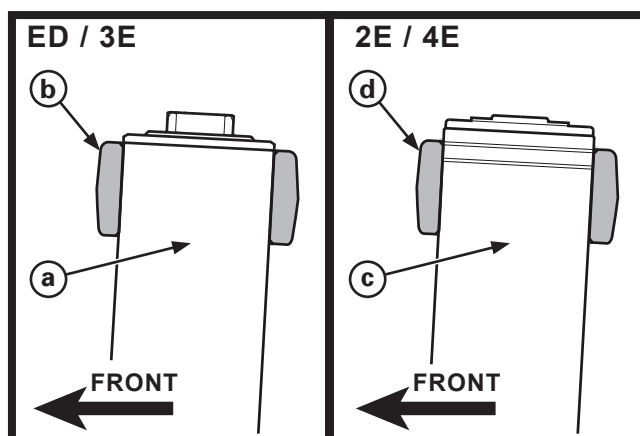

- Tighten the six screws on the fork bridges.

**Torque: 21 N•m (2.1 kgf•m)**

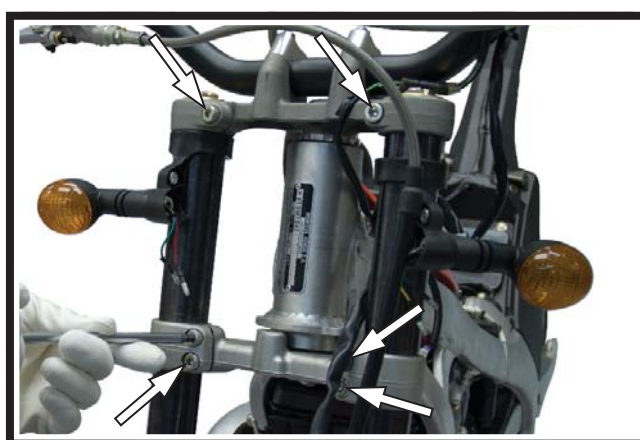

- Remove the gas cable from the gas grip.



- Replace the gas cable between the fork bridges.



(E)

- Reassemble the gas cable in the throttle housing.  
Replace the cover on the throttle housing.



- Remove the clutch lever assembly.



- Replace the clutch hose between the fork bridges, between the gas cable and the brake hose as shown.
- Reassemble the clutch lever assembly on the handlebar.



**Torque: 3.2 N•m (0,33 kgf•m)**

- Attach the metal bracket (61315-REP-J00) supplied in the kit on the bottom of the housing using the screw (90112-REP-J00) supplied in the kit.
- Insert the bulb (34901-REP-J00) in the new headlight housing compartment (61310-REP-J00) supplied in the kit.  
Press down on the bulb until you hear a click.



(E)

- Attach the new headlight wire harness (32101-REP-K00).
- Place the headlight switch (a) inside the headlight housing.
- Connect the wire harness to the bulb (b).
- Fix the wire with two tie-band (c) (90603-NN4-C10).
- Assemble the headlight kit (61300-REP-K00) on the COTA.  
Use the same screw removed from the housing.
- Attach the headlight housing on the top using the two cable ties.
- Connect the new headlight wire harness to the connector on the main harness.

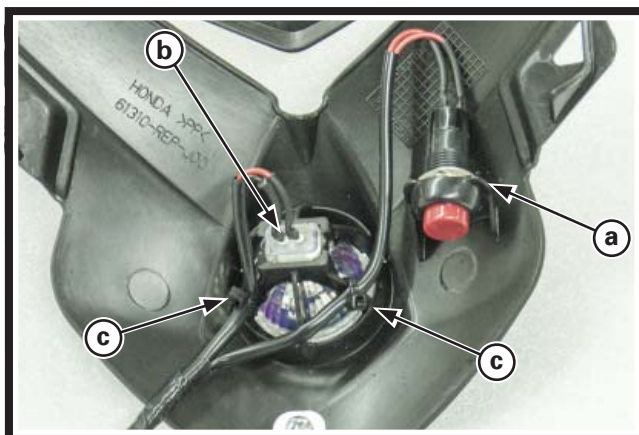



Ⓔ

- Fasten the wire harness on the headlight and the gas cable with a cable tie (61312-NN4-D10) on the left side of the frame.



- Disconnect the connector from the taillights wire harness.
- Remove the taillights wire harness.



- Disconnect the connectors from the horn cable.
- Remove the horn.

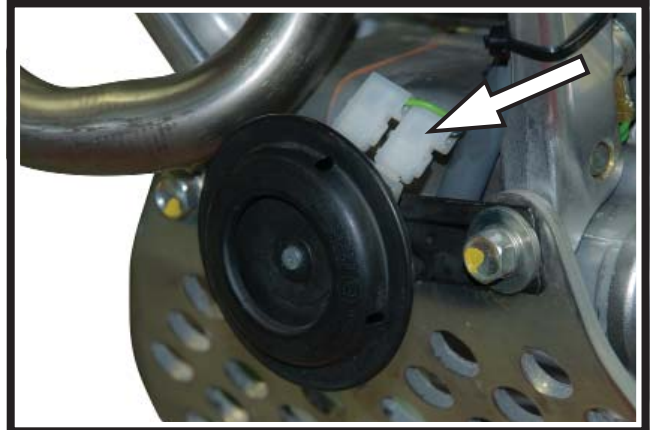

- Disconnect the cable from the rear brake switch.
- Remove the rear brake switch.



(E)

- Remove the speed sensor from the bracket.
- Loosen the flanges on the swingarm and remove the sensor wire.
- Tighten the flanges, holding the rear brake hose once again.



- Remove the section of the wire harness that is no longer being used.



- Install the fan relay in its new location under the insulator, on the adjuster bracket.



- Remove the relay.
- Pass the relay connector under the two oil chamber breather tubes.



(E)

- Cut the cable tie and install the relay cable next to the main wire harness.



- Reattach the relay cable and the wire harness using a new cable tie.



- Bend the relay cable down, behind the wire harness.



- Pass the relay cable under the adjuster bracket tab.

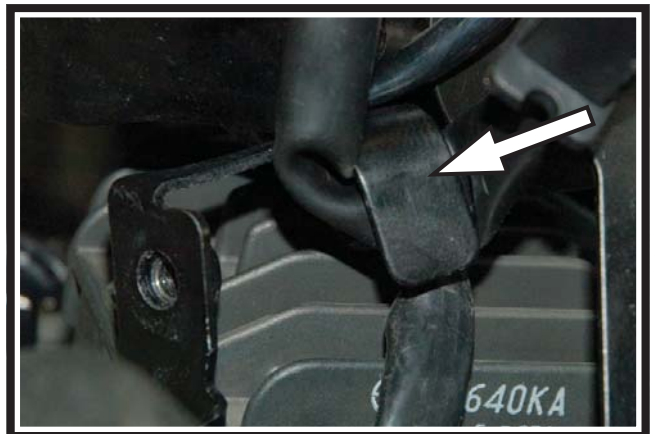



(E)

- Connect the fan relay and attach it to the bracket.



- Fit the filter casing.

**Torque: 10 - 14 N•m (1,0 - 1,4 kgf•m)**

- Connect the breather tube in the filter casing.

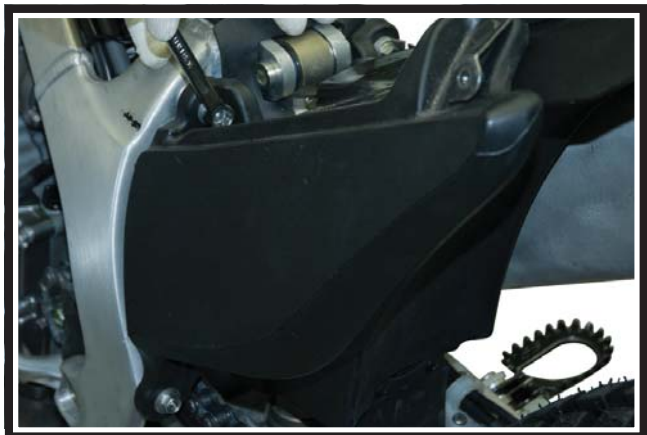

- Tighten the filter casing intake flange.

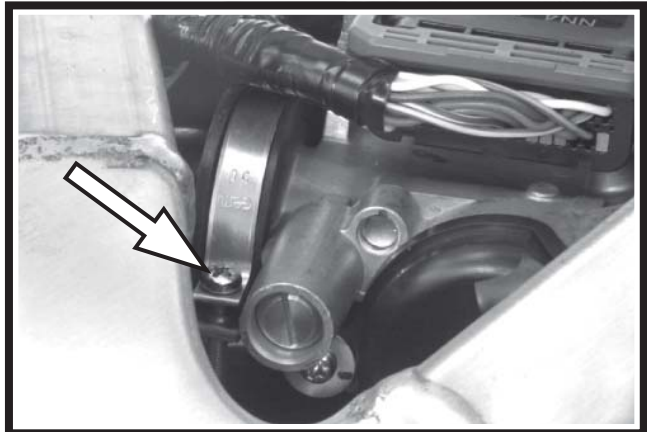

- Fit the fuel tank.  
When fitting the tank, be sure to place tubes and cables in the right places.
- Ensure the injection pump/tank suction hose passes properly under the gas wire.
- Connect the fuel pump black connector 2P.



(E)

- Position the wires and tubes correctly.



- Connect the suction hose to the cylinder head.



- Fit the fuel holder (a).

**Torque: 8 - 12 N•m (0,8 - 1,2 kgf•m)**



Ensure that the injector O-ring is in the correct position.

- Fit the injector connector (b).

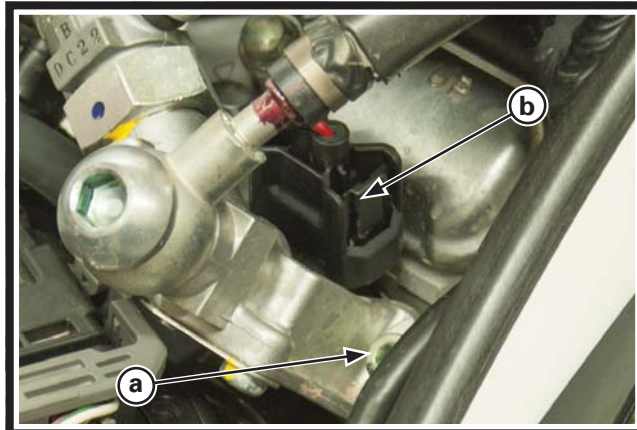

- Fit the exhaust muffler.
- Fit the mounting bolt (c).

**Torque: 10 - 14 N•m (1,0 - 1,4 kgf•m)**

- Tighten the exhaust pipe bracket bolt (d).

**Torque: 18 - 24 N•m (1,8 - 2,4 kgf•m)**

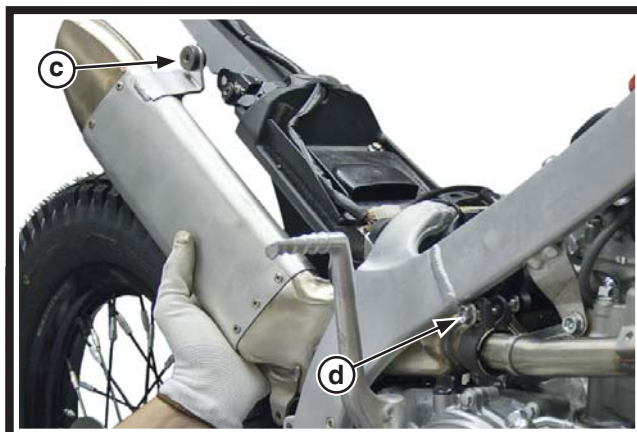

Ⓔ

- Fit the protective cover from the muffler.

**Torque: 10 - 14 N•m (1,0 - 1,4 kgf•m)**



- Fit the rear fender.

**Torque: 8 - 12 N•m (0,8 - 1,2 kgf•m)**





